

14 DAY OPPORTUNITY TO COMMENT

Application for a National Scenic Area Site Review

This notice serves to notify neighboring property owners of the opportunity to submit written comments on the proposal described below. All comments should relate to the approval criteria and any neighbor that submits comments will receive the County's complete decision in the mail. **If you do not wish to submit comments, no response is necessary.**

Case File: T2-2021-14424

Location: Address: 47925 E Historic Columbia River Highway, Corbett
Map, Tax Lot: 1N5E15DD -00900
Alternate Account #: R945150120 Property ID #: R322911

Applicant: Victoria Purvine

Base Zone: Gorge General Residential – 5 (GGR-5)

Key Viewing Areas: Bridal Veil, Cape Horn, Columbia River, Crown Point, Historic Columbia River Highway, I-84, Larch Mountain Road, SR 14

Landscape Setting: Rural Residential

Proposal: National Scenic Area Site Review for repair of an on-site wastewater treatment (septic) system.



Comment Period: Written comments regarding this application will be accepted, if received by **4:00 pm on September 3, 2021**. Comments should be directed toward approval criteria applicable to the request. Further information regarding this application, application materials, and other evidence relied upon for this application is available by contacting the planner, Izze Liu via email at *isabella.liu@multco.us*. Copies of these materials may be purchased for \$0.40/per page.

For this application to be approved, the proposal will need to meet the applicable approval criteria below:

Multnomah County Code (MCC):

General Provisions: MCC 38.0015 Definitions – Parcel, MCC 38.0045 Review and Conditional Use Applications - Submittal Requirements

Violations, Enforcement and Fines: MCC 38.0560 Code Compliance and Applications

GGR-5 Zone: MCC 38.3025 Review Uses, MCC 38.3060 Dimensional Requirements

NSA Site Review: MCC 38.7035 GMA Scenic Review Criteria, MCC 38.7045 GMA Cultural Resource Review Criteria, MCC 38.7055 GMA Wetland Review Criteria, MCC 38.7060 GMA Stream, Lake and Riparian Area Review Criteria, MCC 38.7065 GMA Wildlife Review Criteria, MCC 38.7070 GMA Rare Plant Review Criteria, MCC 38.7080 GMA Recreation Resource Review Criteria

Copies of the referenced Multnomah County Code sections can be obtained by contacting our office or by visiting our website at <https://multco.us/landuse/zoning-codes/> under the link **Chapter 38 – Columbia River Gorge National Scenic Area**

Decision Making Process: The Planning Director will render a decision on this application after the comment period expires. Notice of the Director's decision will be mailed to the applicant, parties within 750 feet of the subject property, and any other persons who submitted written comments during the comment period. The Planning Director's decision can be appealed. An explanation of the requirements for filing an appeal will be included in the notice of decision.

Important Note: Failure to raise an issue before the close of the public record in sufficient detail to afford the County and all parties an opportunity to respond may preclude appeal on that issue to the Columbia River Gorge Commission.

Enclosures:

Site Plan

Notice to Mortgagee, Lien Holder, Vendor, or Seller:

ORS Chapter 215 requires that if you receive this notice it must be promptly forwarded to the purchaser.

1" = 25'

#1

330'

363.33

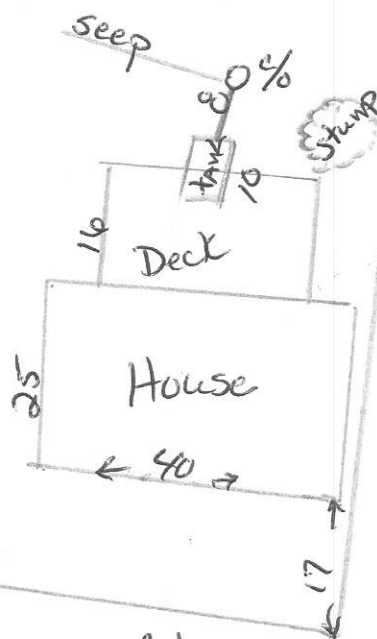

47925
SE Historic Col.
River Hwy

1"=25'

#2
Proposed

330

79'

47925 SE
Columbia River Hwy

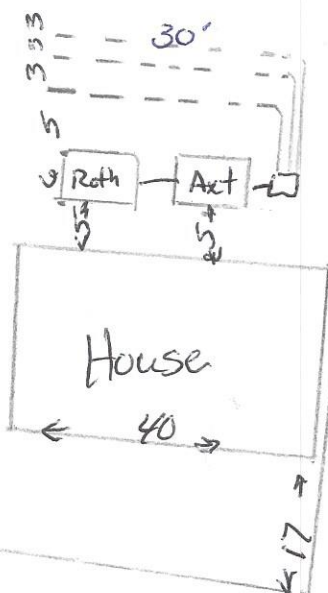

303.33

Drain lines 3' apart