

Entry on SW Madison and SW First

Multnomah County Central Courthouse



ENTRANCE FROM SW FIRST AVENUE AND SW MADISON STREET

Entry Sequence

- The entry to the Courthouse ties into the existing city fabric, connecting the Courthouse to the urban fabric of Portland.
- The main lobby has a three story atrium that acts as a welcoming entrance to the Courthouse.
- The queuing capacity within the building is for more than 80 people as well as a covered raised plaza just outside the doors for capacity for an additional 100 people.
- The staircase acts as a natural procession taking one through a journey. Entering off the busy city street and ascending to the second and third floor which have the highest number of visitors and also a view over looking the Willamette River.
- The building will be fully ADA compliant.

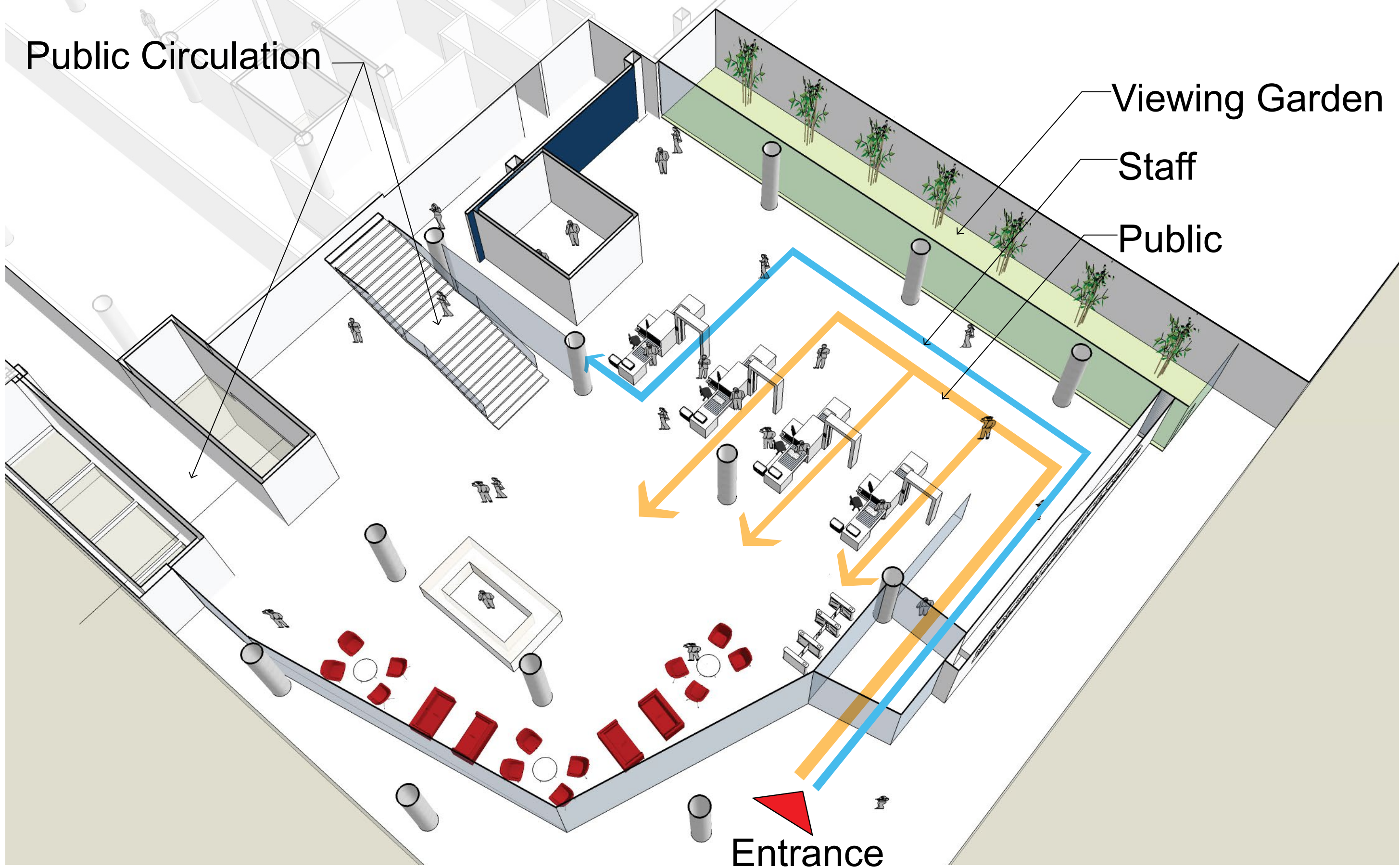

ENTRY SEQUENCE DIAGRAM

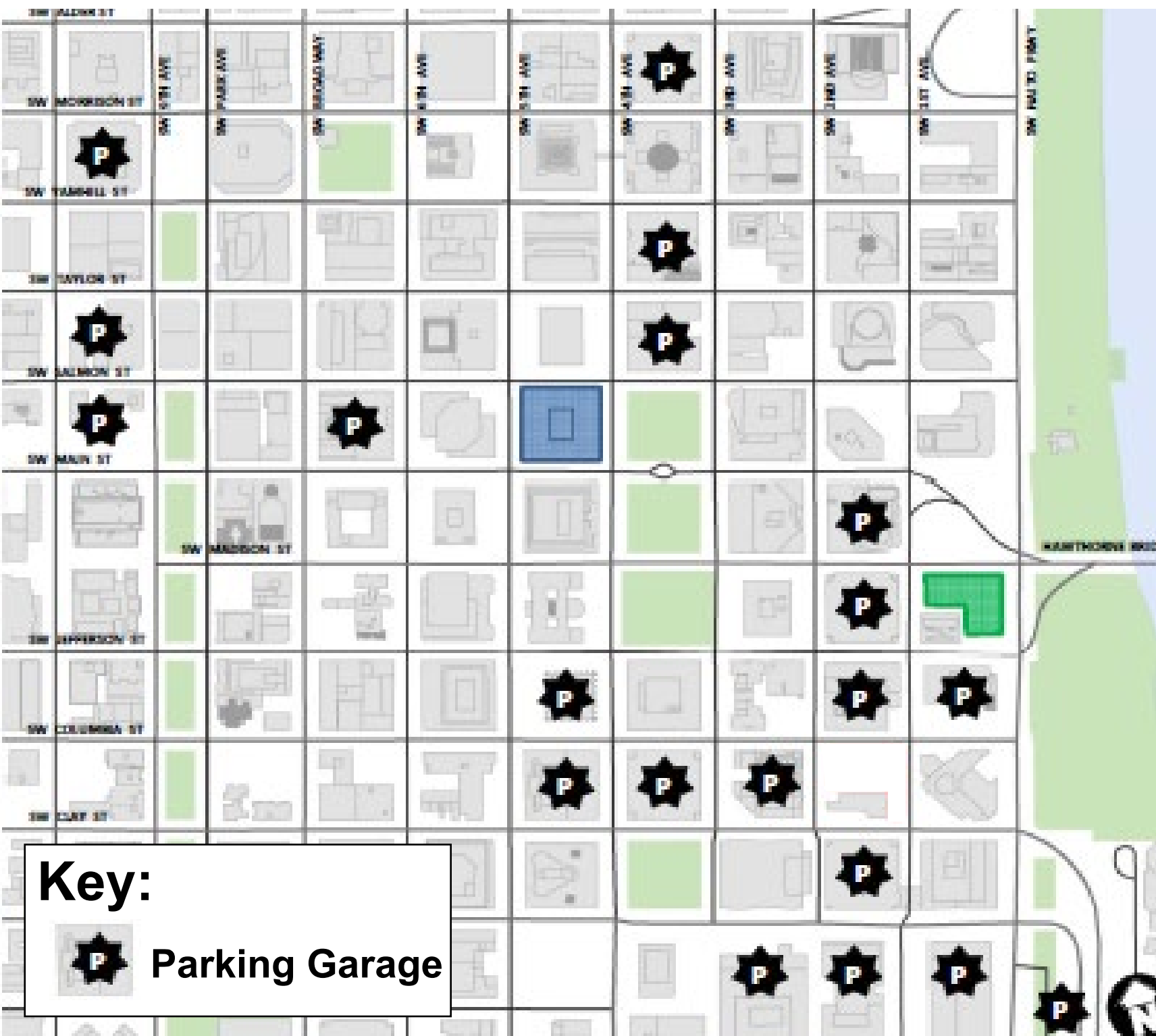

PARKING GARAGE

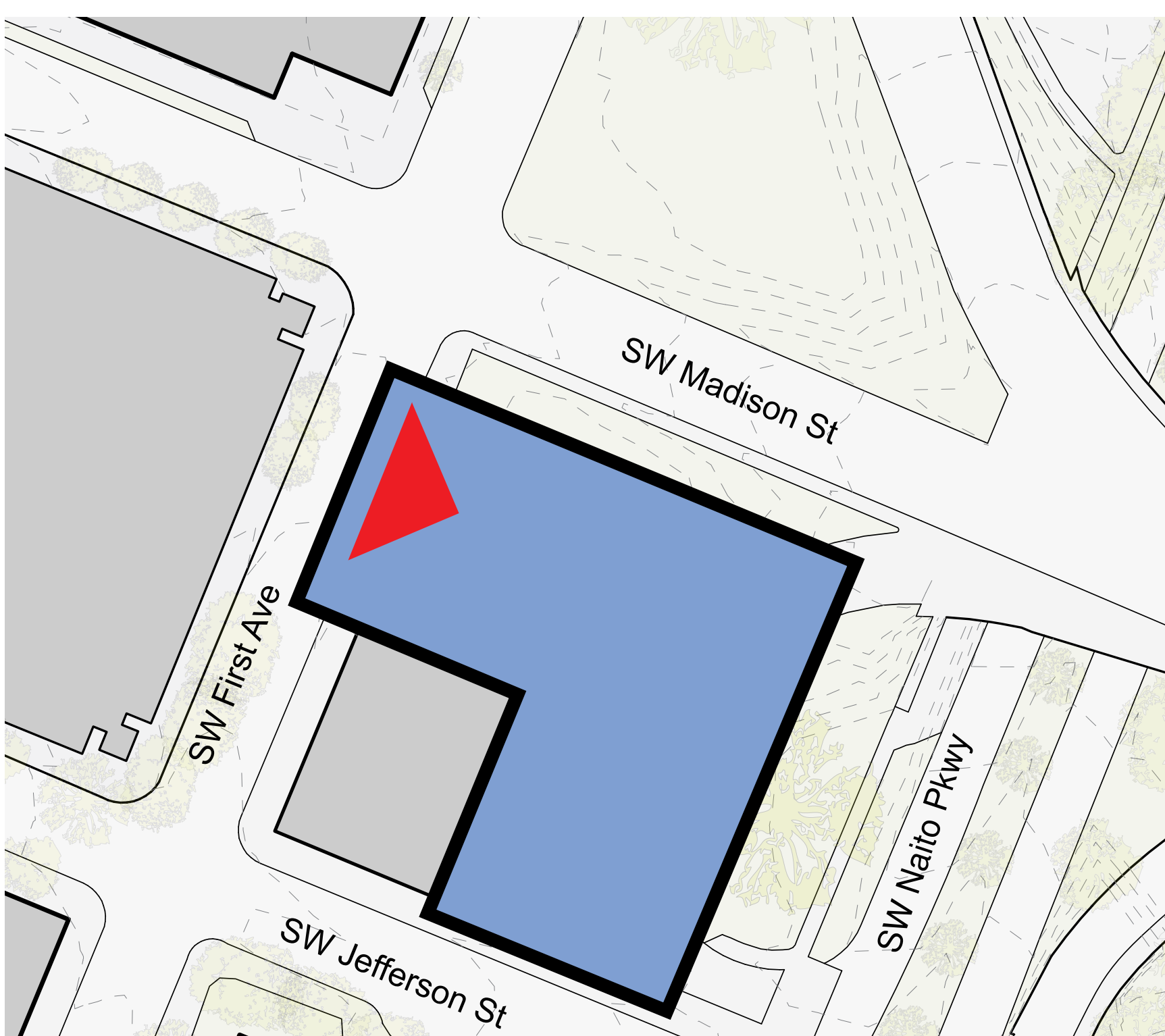

ENTRANCE FROM SW FIRST AND SW MADISON

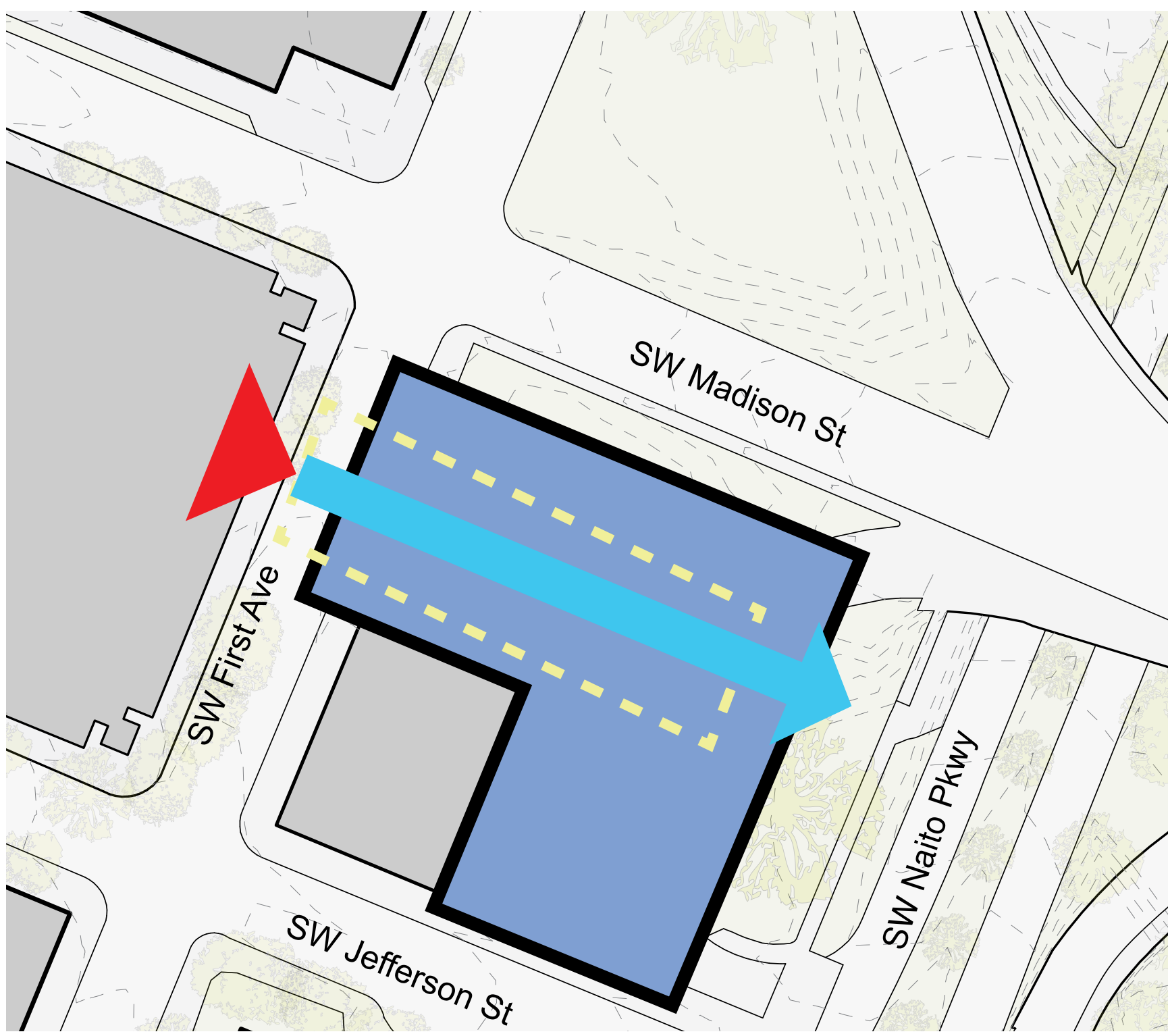

PUBLIC PROCESSION

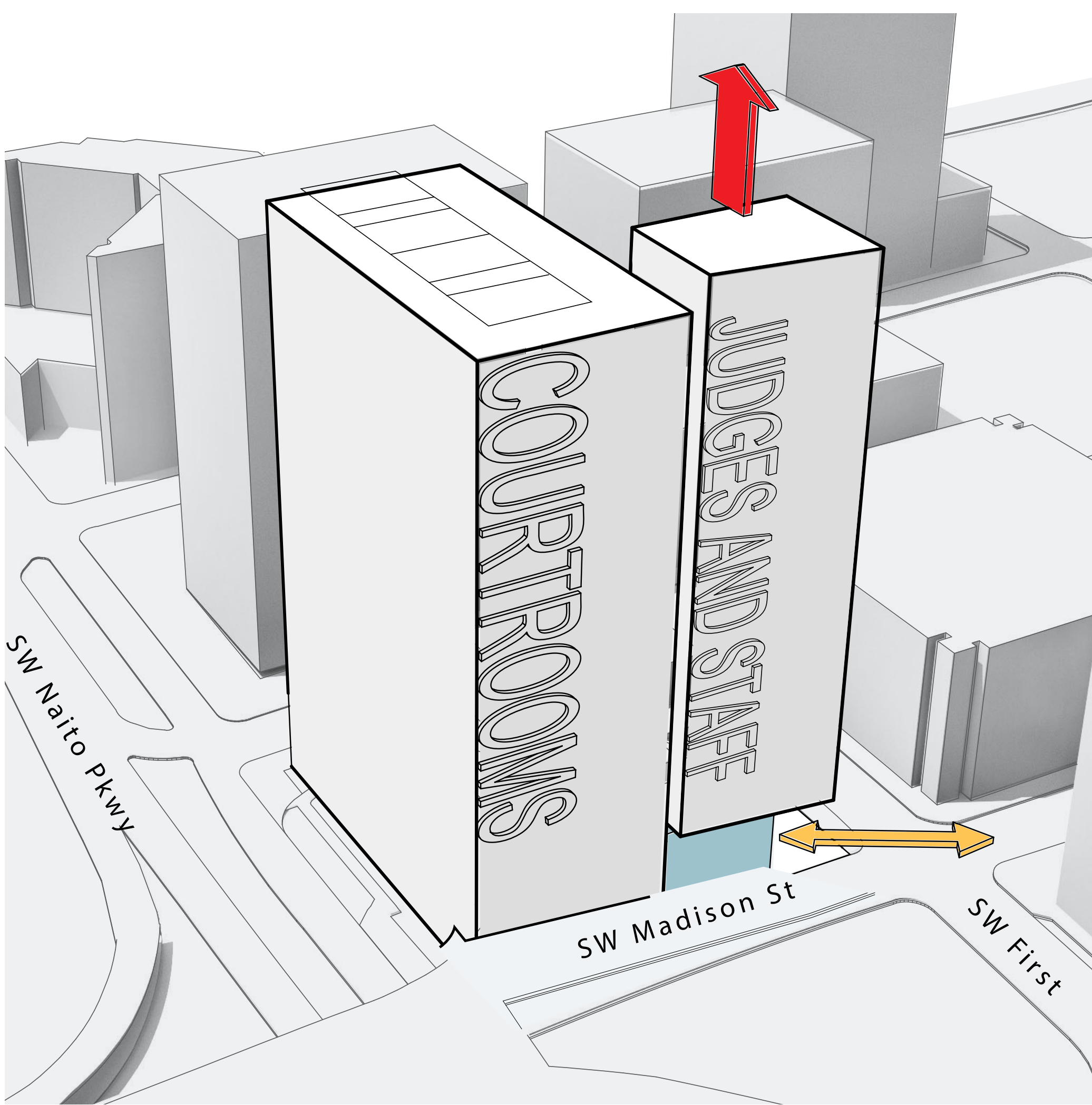

BUILDING MASSING

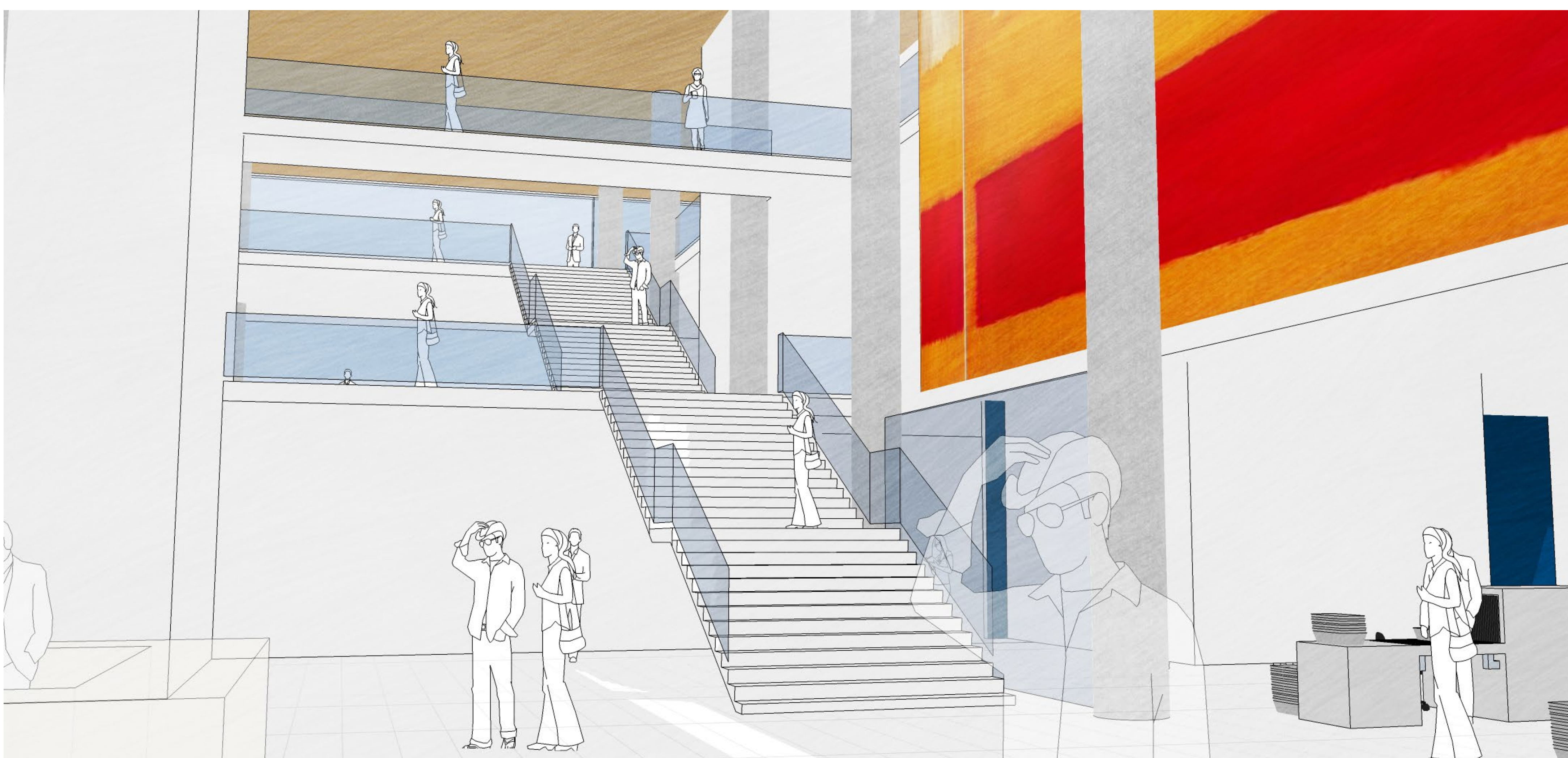

LOBBY PERSPECTIVE STUDY

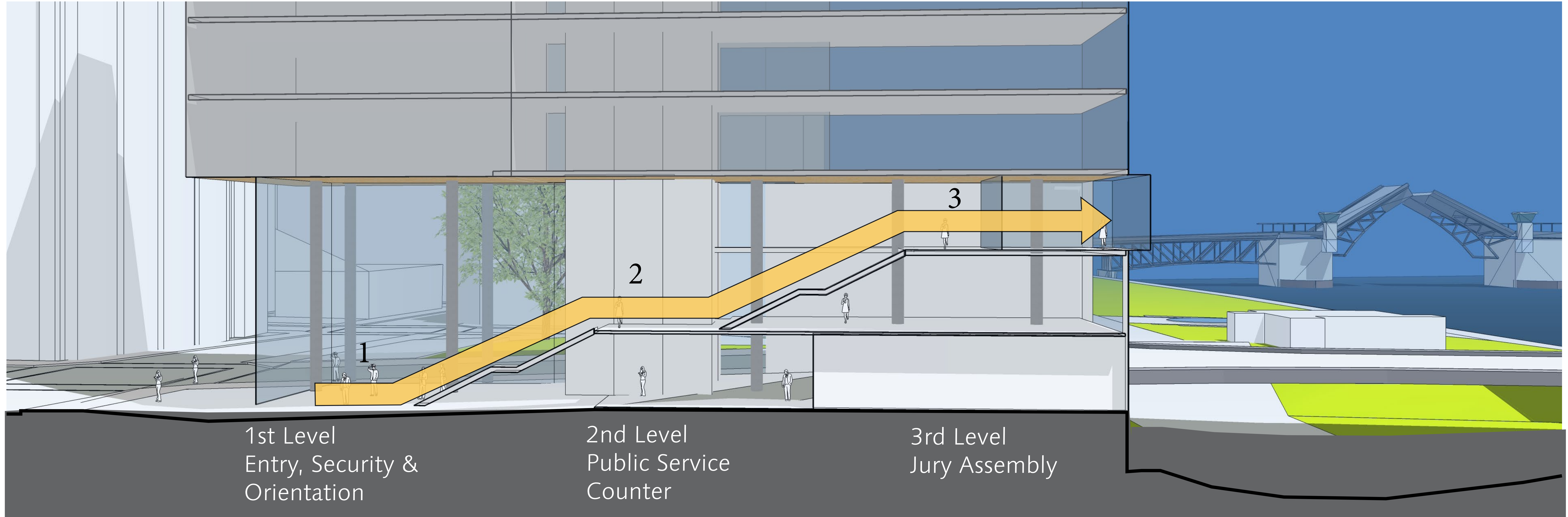

LOBBY SECTION DIAGRAM

NOTE: ALL DESIGN INFORMATION IS IN DRAFT FORM AND SUBJECT TO CHANGE